

MINIMUM CLEARANCE FROM CEILING

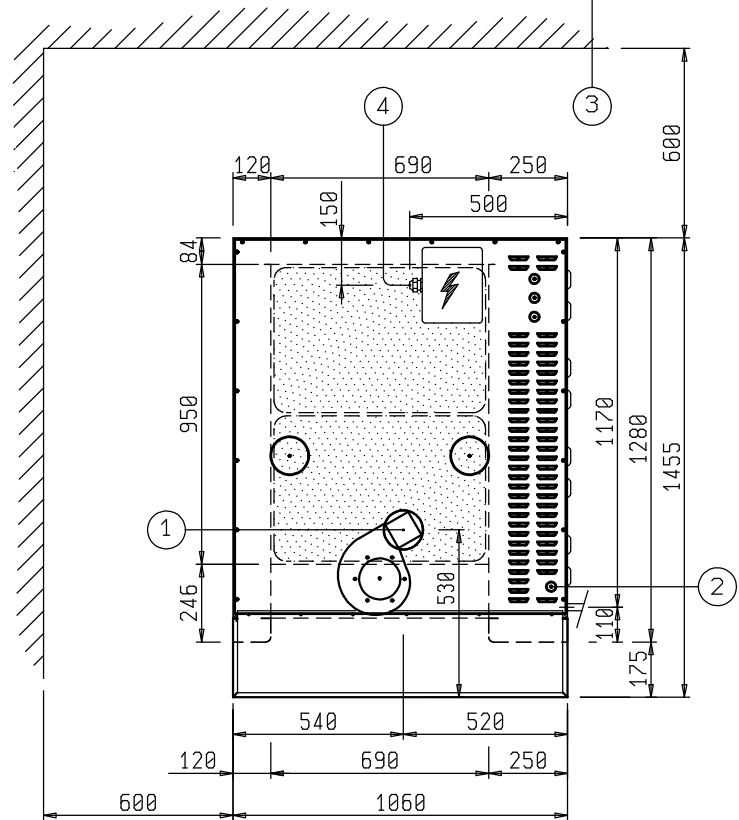
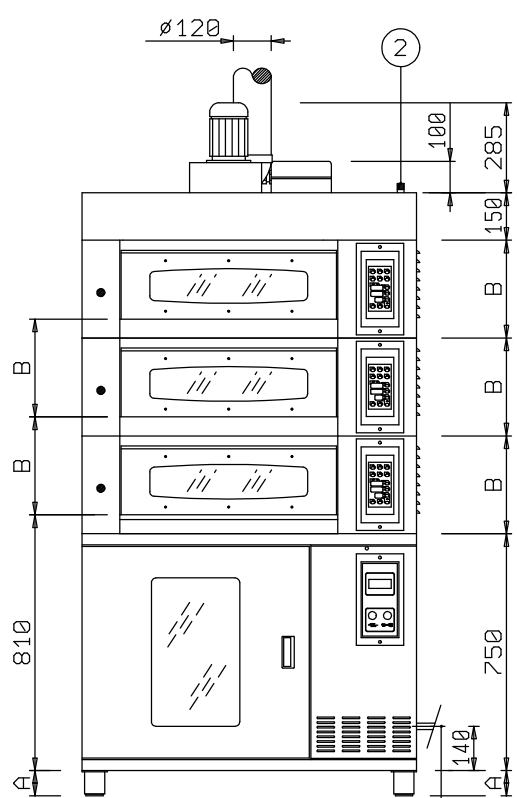

| OVEN TYPE  | A   |
|------------|-----|
| 1 CHAMBER  | 190 |
| 2 CHAMBERS | 190 |
| 3 CHAMBERS | 80  |

| USEFUL H. | 180 | 230 | 280 |
|-----------|-----|-----|-----|
| B         | 310 | 360 | 410 |

| TECHNICAL FEATURES                                    | WITH ECONOMIZER | /    |
|---|-----------------|------|
| INSTALLED POWER FOR SINGLE CHAMBER (KW)               | 2,5 KW          | 5 KW |
| AVERAGE CONSUMPTION FOR SINGLE CHAMBER                | 3,3 KW/H        |      |
| INSTALLED POWER PROOFER                               | 0,5 KW          |      |
| AVERAGE CONSUMPTION PROOFER                           | 0.3 KW          |      |
| ELECTRIC POWER FOR STEAM GENERATOR FOR SINGLE CHAMBER | 0,7 KW          |      |
| USEFUL DIMENSIONS BAKING CHAMBER                      | 690X950         |      |
| MINIMUM PASSAGE FOR DISSEMBLED OVEN                   | 800 X 1100      |      |

|                           |       |
|---------------------------|-------|
| 1 STEAM EXHAUST PIPE      | ∅120  |
| 2 WATER ARRIVAL           | ∅1/2" |
| 3 WATER DISCHARGE         | ∅1/2" |
| 4 ELECTRIC ENERGY ARRIVAL |       |

**SU 46X66 OVEN WITH PROOFER**

 DATA . . . . . VISTO . . . . . DATA 26.03.07  
 BOLL. . . . . DIS. SA. . . . . DIS.N° POS/578  
 Sistema Qualita' DISEGNO DI PROPRIETA' RISERVATA E NON PUO' ESSERE RIPRODOTTO O MOSTRATO A TERZI AI SENSI DI LEGGE